



SwissLife
Asset Managers



Logistics

Nuremberg West I

Steinacher Straße, 91593 Burgbernheim

In the Logistics usage class of Swiss Life Asset Managers, we are a developer, investor and portfolio holder for state-of-the-art logistics real estate – including our new property “Nuremberg West I”, with high ESG standards and high-quality fittings.

Highlights

 **110.500sqm**
Property area

 **57.166sqm**
Warehouse

 **A7/4km**
Connection

 **3.133sqm**
Office and social areas

 **6.193sqm**
Mezzanine

Location and surroundings

Macro location:

The Würzburg/Schweinfurt logistics region is located in northwestern Bavaria near Schweinfurt, Würzburg, Kitzingen and Uffenheim. While Schweinfurt has developed into an attractive location for contract logistics providers serving the local industry, the Würzburg/Kitzingen/Uffenheim area plays an important supply function for the retail sector. Located at the intersection of the A7 and A3 freeways, the Würzburg/Schweinfurt region’s good connection to the national transportation network makes it an efficient central supply point.





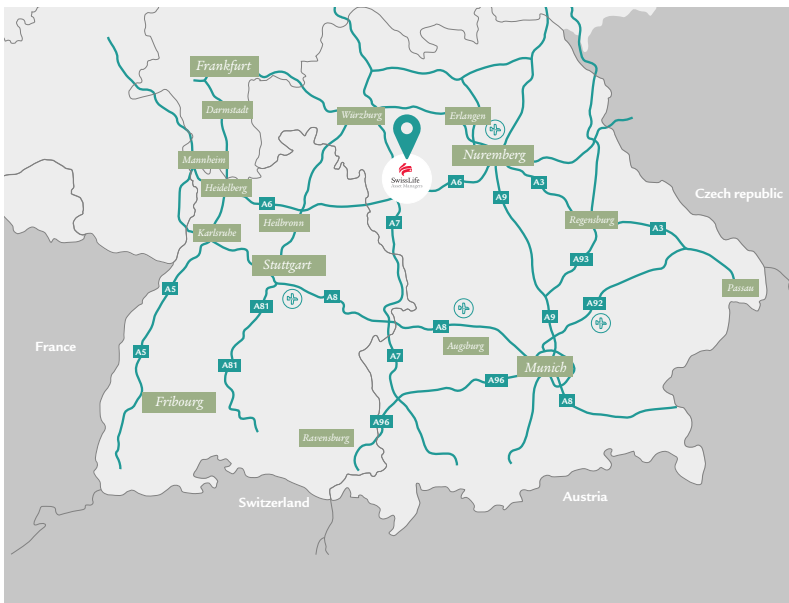

Micro location:

The site is located in an industrial area with local and medium-sized companies. In immediate vicinity are the main road (B470) and the A7, which intersects with the A3 approx. 45 km further north, thus connecting the location with large supra-regional centres such as Nuremberg/Munich and RheinMain.

Macro location



Entfernungen

	Burgbernheim	approx. 1 km
	GVZ Nuremberg	approx. 60 km
	Albrecht Dürer Airport	approx. 60 km
	Motorway A7	approx. 4 km
	Motorway A3	approx. 45 km
	Port of Nuremberg	approx. 60 km

Micro location

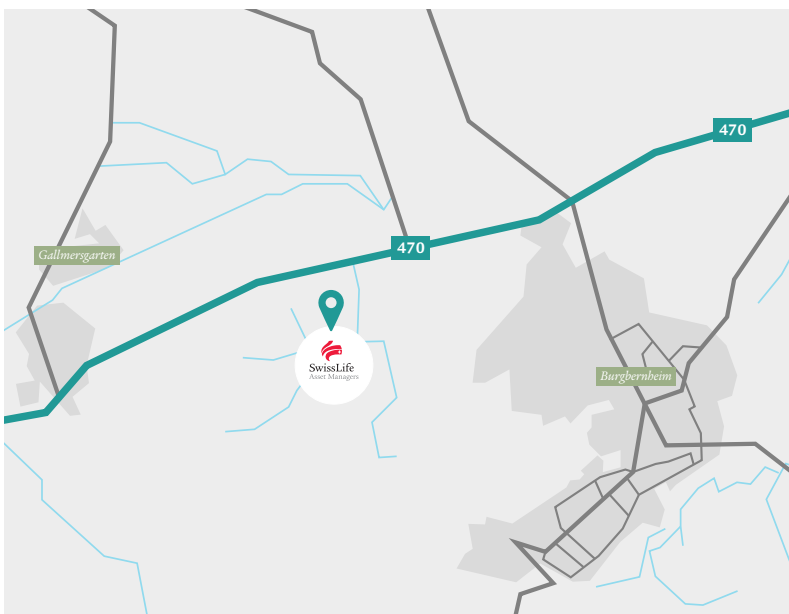

«This state-of-the-art property in the heart of the thriving Nuremberg metropolitan region is a great continuation of our “Roots” development pipeline.»

Ingo Steves, Managing Partner Logistics at Swiss Life Asset Managers

Location and surroundings

The Nuremberg logistics region has an efficient infrastructure that allows it to fulfil its role as a gateway location for international transport. In this regard, the Nuremberg freight transport centre (GVZ) acts as a fundamental infrastructure facility. The freight transport and logistics center is an important hub for transport to and from the North Sea ports, offering daily container train connections to Hamburg, Bremerhaven, Bremen, Verona, and Rotterdam.

In terms of its level of development, the GVZ Nuremberg is one of the most established freight transport centers in Germany, along with Bremen. Conventional bulk materials can also be transported via the adjacent port area. Nuremberg is strategically located at the intersection of the major national A3, A6, A9, and A73 motorways, offering efficient distribution and transportation to neighboring regions. Nuremberg Airport is equipped to handle air freight.

Location in Germany and Europe

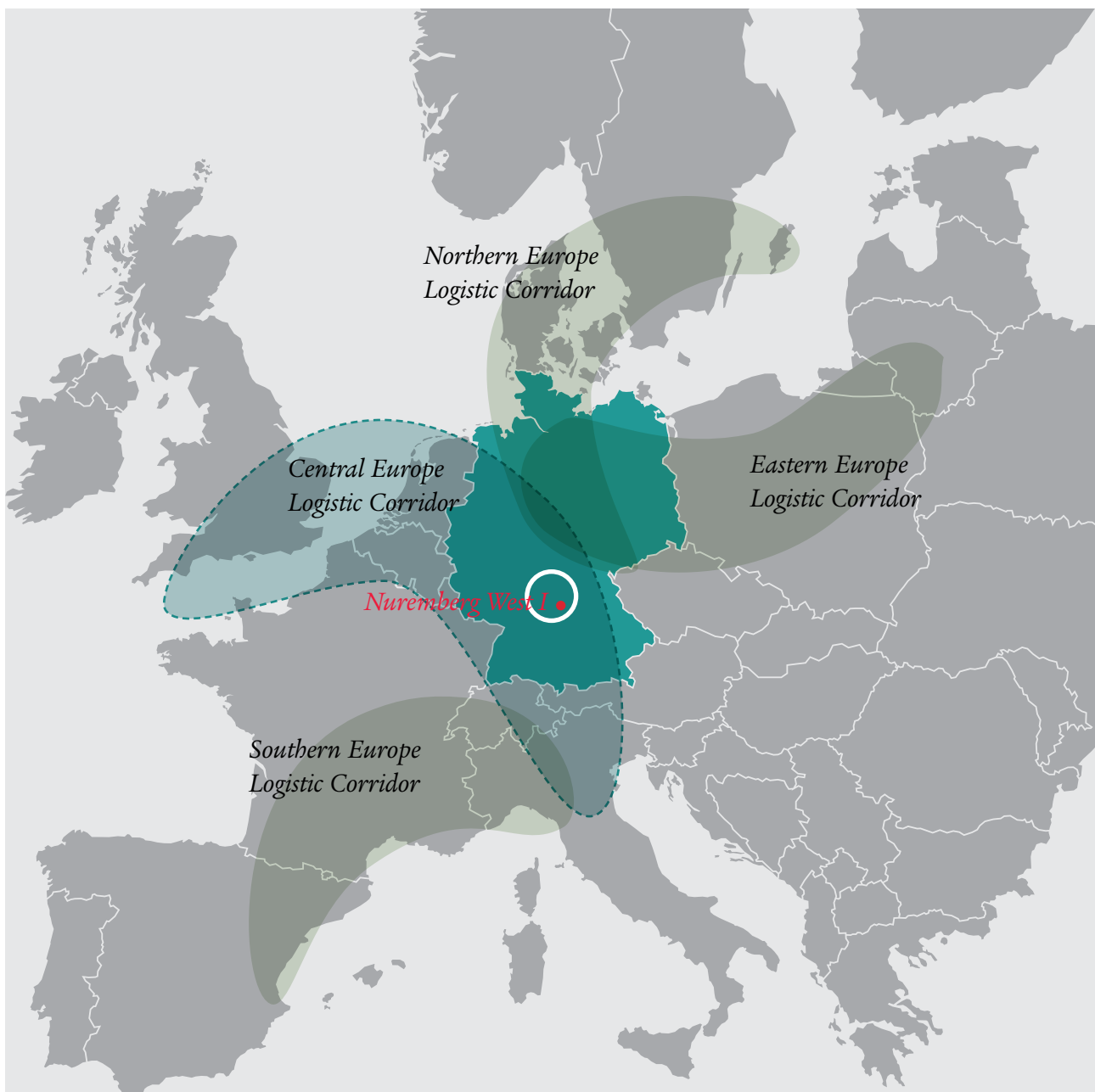

Property description

In Burgbernheim, in the Nuremberg/Würzburg region, an attractive logistics property with approximately 57.166 square meters of warehouse space and almost 6.193 square meters of mezzanine space is being built on a site measuring approximately 110.500 square meters. The approximately 3.133 square meters of office and social space will be complemented by employee-friendly indoor and outdoor recreation facilities.

In addition to its attractive appearance with a wooden facade and petroleum-colored design, the property also features electric charging stations for cars and trucks, a photovoltaic system, heat pumps, greenery on the facade, and flower meadows. The result is a building that has been designed for the efficient handling of goods and the best possible working conditions in the logistics hall.



«In our properties, we focus on meeting flexible customer needs and adhering to international sustainability standards in order to generate the greatest possible long-term benefit for our clients.»

Alexander Schmid, Head Development Logistics at Swiss Life Asset Managers

Building specification

- | | |
|----------------------------------|---|
| ✓ Photovoltaic systems | ✓ 60 car parking spaces and 7 truck parking spaces |
| ✓ Heat pumps | ✓ 66.492 sqm total rental area |
| ✓ Green-landscaped facades | ✓ 57.166 sqm warehouse |
| ✓ Generous, underground drainage | ✓ 6.193 sqm mezzanine area |
| ✓ WGK3 capable | ✓ 3.133 sqm of high-quality office and social space |

Floor plan

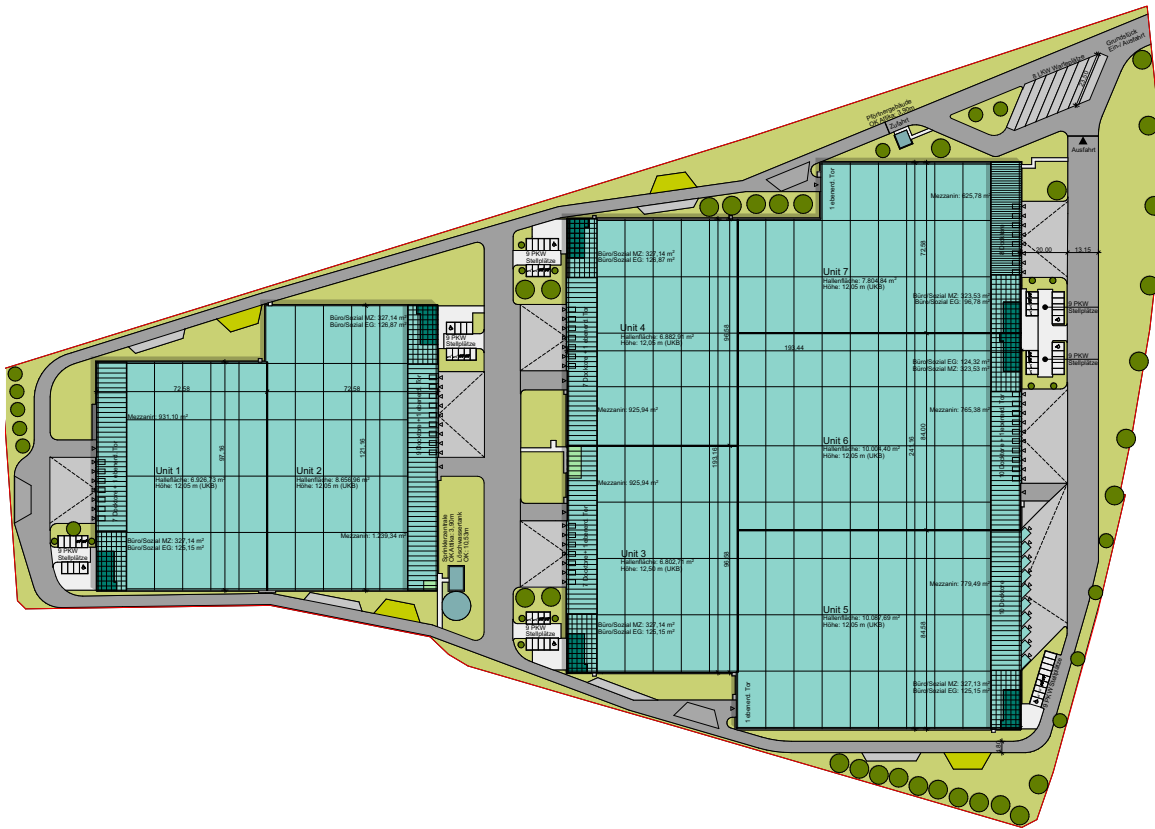

Swiss Life Asset Managers

Swiss Life Asset Managers has more than 165 years of experience in managing the assets of the Swiss Life Group. This insurance heritage has decisively shaped the investment philosophy. The focus is on overriding principles such as value preservation, the generation of long-term and stable returns and a responsible approach to risk. Swiss Life Asset Managers also makes this proven approach available to third-party clients in Switzerland, France, Germany, Luxembourg, the UK, Italy and the Nordic countries.

In the Logistics asset class, Swiss Life Asset Managers acts as an investor, developer and portfolio holder of high-quality logistics, distribution, and commercial real estate, offering clients a comprehensive range of services. With its development activities in Germany and other European countries, the logistics team at Swiss Life Asset Managers facilitates sustainable supply chains, ensures security of supply and creates local added value.



272.3 billion

Assets under management for the Swiss Life Group



>112.7 billion

Total real estate managed and administered



>165 years

of knowledge and experience in risk management

Your contact

If you have any further questions or would like to make an appointment, please contact us:

Swiss Life Asset Managers Logistics GmbH
Kurfürstendamm 188
10707 Berlin

E-Mail: Vermietung-Logistics@swisslife-am.com

<https://de.swisslife-am.com/en/home/real-estate/logistics.html>

Disclaimer

This document has been prepared by a legal entity of Swiss Life Asset Managers (hereinafter 'Swiss Life Asset Managers'). This document is for marketing and information purposes only.

This document has not been registered with any supervisory authority (including the CSSF, the Federal Financial Supervisory Authority, the Autorité des Marchés

Financiers, the Autorité de Contrôle Prudentiel et de Résolution and the Swiss Financial Market Supervisory Authority FINMA). No regulatory authority has confirmed the accuracy or adequacy of the information contained in this document. Any addressee of this document must seek internal and/or external advice, including from a financial, legal, tax or investment advisor or other specialist, to verify that a potential investment meets its objectives and legal and tax requirements.

Swiss Life Asset Managers has made all reasonable endeavours to ensure that the facts stated in this document are true and correct in all material respects and that there are no other material facts the omission of which would make this document misleading. Some of the information contained in this document has been obtained from published sources prepared by other parties. Neither Swiss Life nor the Swiss Life Group nor any other person (including any of the directors of the companies mentioned, their employees, agents and/or shareholders) accepts any responsibility for the accuracy or completeness of this information. No representation, warranty or undertaking, express or implied, is made to the recipients of this document as to, or in relation to, the accuracy or completeness or otherwise of this document or as to the reasonableness of any assumption contained in this document.

This document may contain 'forward-looking statements' that express our judgement and expectations for a particular point in time. Various risks, uncertainties and other factors could cause actual developments and results to differ materially from our expectations.

'Swiss Life Asset Managers' is the brand name for the asset management activities of the Swiss Life Group. More information at www.swisslife-am.com. All rights reserved.

Weitere Informationen erhalten Sie auch unter:

<https://www.swisslife-am.com/logistics>